

Project

London Aquatics Centre

Location

London,
United Kingdom

Date

2005 / 2011

Client

Olympic Delivery
Authority

Status

Under Construction

Size

20,000m²



04



01



05

Design Concept

The architectural concept of the London Aquatic Centre is inspired by the fluid geometry of water in motion, creating spaces and a surrounding environment in sympathy with the river landscape of the Olympic Park. An undulating roof sweeps up from the ground as a wave - enclosing the pools of the Centre with its unifying gesture of fluidity, whilst also describing the volume of the swimming and diving pools. The London Aquatic Centre is designed to have the flexibility to accommodate the size and capacity of the London 2012 Olympic Games whilst also providing the optimum size and capacity for use in Legacy mode after the 2012 Games.

Site Context

The London Aquatic Centre is situated within the Olympic Park Masterplan. The site is positioned on the south eastern edge of the Olympic Park with direct proximities to Stratford. The new pedestrian access from the east-west bridge called the Stratford City Bridge which links the Stratford City development with the Olympic Park will cross over the LAC. This will provide a very visible frontage for the LAC along the bridge. Several smaller pedestrian bridges will connect the site to the Olympic Park over the existing canal.

The Aquatic Centre addresses within its design the main public realm spaces implicit within the Olympic Park and Stratford City planning. These are primarily the east-west connection of the Stratford City Bridge and continuation of the Olympic Park space alongside the canal.



02

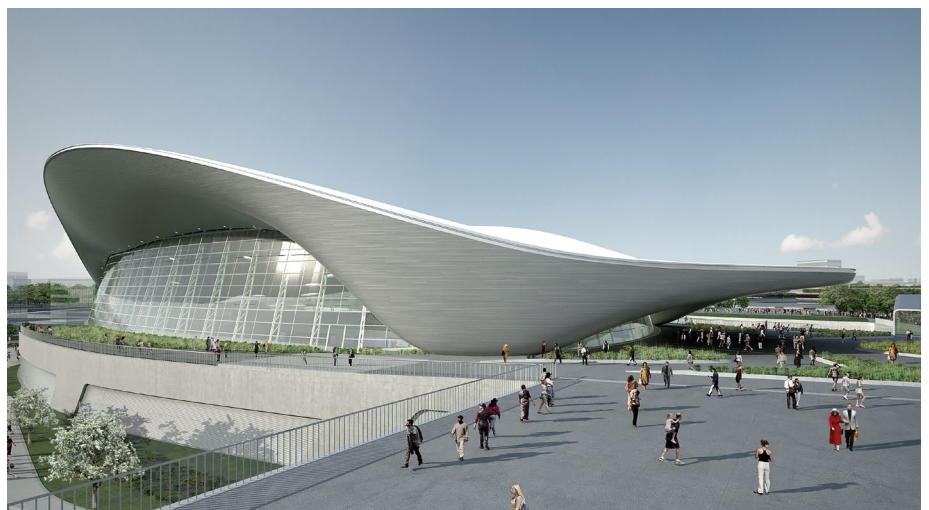

03

Design
Zaha Hadid Architects

Project Director
Jim Heverin

Project Architect
Glenn Moorley
Sara Klomps

Project Team
Alex Bilton
Alex Marcoulides
Barbara Bochnak
Carlos Garijo
Clay Shorthall
Ertu Erbay
George King
Giorgia Cannici
Hannes Schafelner
Hee Seung Lee
Kasia Townend
Nannette Jackowski
Nicolas Gdalewitch
Seth Handley

Thomas Soo
Tom Locke
Torsten Broeder
Tristan Job
Yamac Korfali
Yeena Yoon

Project Team (Competition)
Saffet Kaya Bekiroglu
Agnes Koltay
Feng Chen
Gemma Douglas
Kakakrai Suthadarat
Karim Mualllem
Marco Vanucci
Mariana Ibanez
Sujit Nair

Sports Architects
S+P Architects
(London)

Structural Engineer
Ove Arup & Partners
(London, Newcastle)

Services
Ove Arup & Partners
(London)

Fire Safety
Arup Fire
(London)

Acoustics
Arup Acoustics
(London)

Façade Engineers
Robert-Jan Van Santen
Associates
(Lille)

Lighting Design
Arup Lighting
(London)

Kitchen Design
Winton Nightingale
(London)

Maintenance Access
Reef
(London)

Temporary Construction
Edwin Shirley Staging
(London)

Security Consultant
Arup Security
(London)

AV + IT Consultants
Mark Johnson Consultants
(London)

Access Consultants
Access = Design
(London)

CDM Co-ordinator
Total CDM Solutions
(Cardigan)

BREEAM Consultant
Ove Arup & Partners
(London)

Layout

The Aquatic Centre is planned on an orthogonal axis perpendicular to the Stratford City Bridge. Along this axis are laid out the three pools. The training pool is located under the bridge whilst the competition and diving pools are within a large volumetric pool hall. The overall strategy is to frame the base of the pool hall as a podium by surrounding it and connecting it into the bridge.

This podium element allows for the containment of a variety of differentiated and cellular programmatic elements into a single architectural volume which is seen to be completely assimilated with the bridge and the landscape. From the bridge level the podium emerges from underneath the bridge to cascade around the pool hall to the lower level of the canal side level.

The pool hall is expressed above the podium level by a large roof which is arching along the same axis as the pools. Its form is generated by the sightlines for the spectators during the Olympic mode. Double-curvature geometry has been used to create a structure of parabolic arches that create the unique characteristics of the roof. The roof undulates to differentiate an internal visual separation inside the pool hall between the competition pool volume and the diving pool volume. The roof projects beyond the base legacy pool hall envelope to extend the roof covering to the external areas of the cascades and the bridge entrance. The roof projection over the bridge entrance announces the London Aquatic Centre's presence from the approach from either Stratford City or the Olympic Park. Structurally the roof is grounded at 3 primary

positions. Otherwise the opening between the roof and the podium is in-filled with a glass façade.

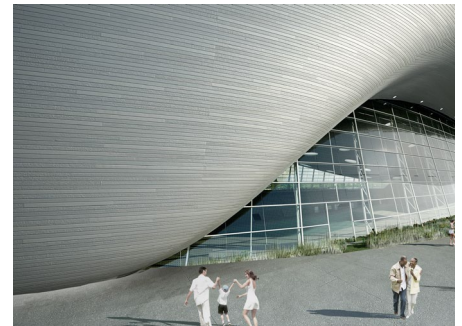

06



07